

The Welker® ALS Analyzer Liquid Shutoff prevents any liquid from entering your gas chromatograph, keeping the analyzer columns safe from damage and protecting sensitive equipment from expensive repairs.

Features

- Fail-safe shutoff in the presence of liquids
- Sight port for instant visual confirmation of flow status
- Corrosion resistant material

Benefits

- Optimizes profitability by protecting sensitive equipment from liquid damage
- Quick and easy installation
- Simple maintenance



SPECIFICATIONS

ALS ANALYZER LIQUID SHUTOFF

ALS

Materials of Construction	316/316L Stainless Steel, Glass, LEXAN™, Teflon®, Viton®
Inlet Connection	1/8" FNPT
Outlet Connection	1/8" FNPT
Operating Pressure	1000 psig @ -20 °F to 120 °F
Product Certification	NACE Compliance

STANDARD OPTIONS

ALS ANALYZER LIQUID SHUTOFF

BODY
MATERIAL

ALS

1

316/316L
Stainless
Steel

For custom options, choose **Plus Welker™**.



Customer Inspired. Welker Manufactured.

Collaborate with us to create a custom product unique to your application.

DIMENSIONS

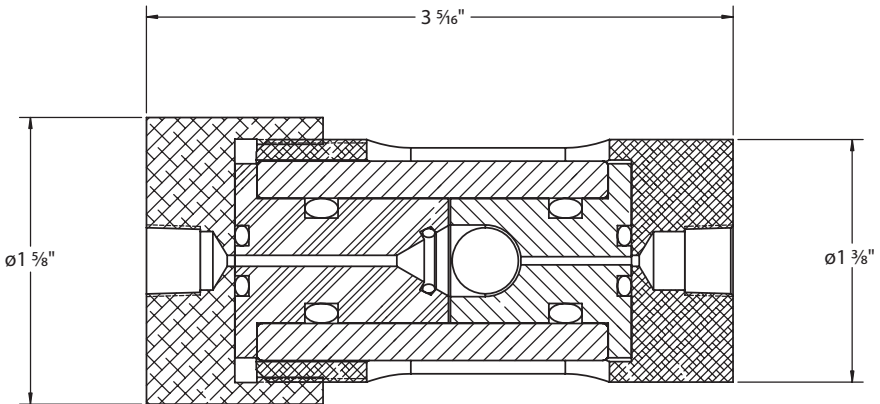

Weight and/or dimensions are approximate.
Specifications subject to change without notice.

